

RECOMMENDED SOLDERING PCB LAYOUT

TOLERANCE(.XX±0.05)

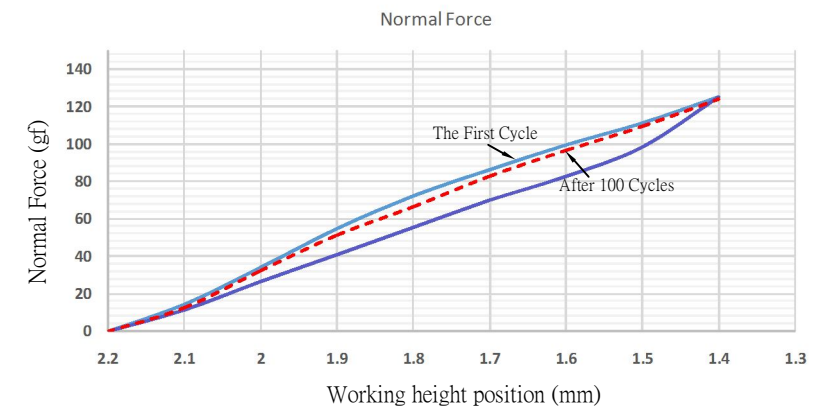

- Note:
1. Material: Phosphorus Bronze Thickness 0.12mm
  2. Electroplate:  
Au >1u" on contact area  
Gold Flash on solder area  
Nickel underplating over all
  3. Electrical Characteristics:  
3-1 Current Voltage: 12V  
3-2 Current Rate: 3A  
3-3 Contact Resistance: Normal Compression < 30mΩ
  4. Working Height of Application: 1.4~1.8mm
  5. Spring Force Tolerance is ±20gf
  6. Operating Temperature: -20℃~+85℃

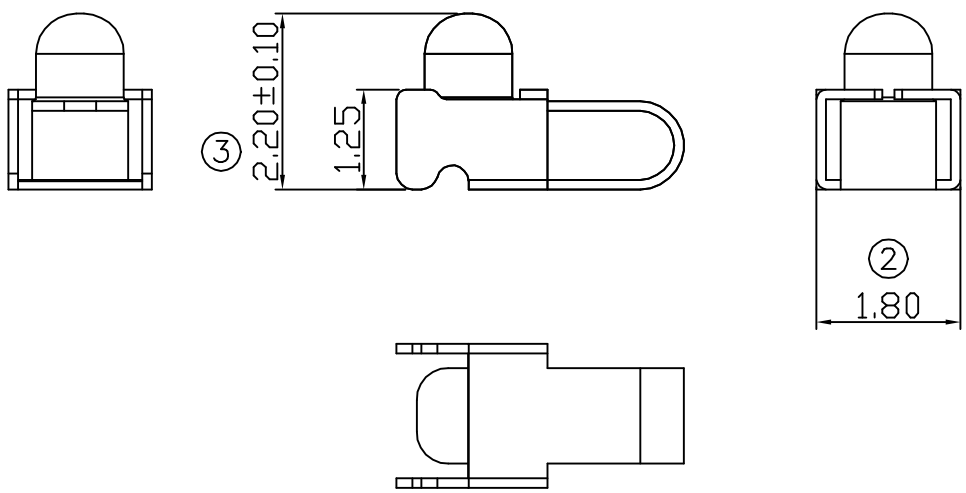
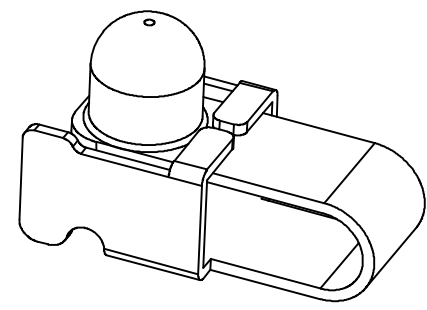

00	03/04-'13	Design creation	
REV	Date	Description	
DRAFT	DATE	<b>RoHS Compatible</b>	
Gabby Weng	03/04-'13		
CHECKER	DATE		
Jacky Lin	03/04-'13		
APPROVAL	DATE	SHEET	SCALE
Jacky Lin	03/04-'13	1-2	Not to scale
		UNIT	

TOLERANCE/CLASS			
RANGE(mm)	1	2	3
≤30	±0.10	0.15	0.20
30<- ≤120	±0.15	0.20	0.30
120<- ≤300	±0.20	0.30	0.50
300<	±0.30	0.50	0.80
ANGLES	±2.5°		

**EMI STOP CORP.**

EMI STOP  
QQ-22Q1G

CUS P/N