

RECOMMENDED SOLDERING PCB LAYOUT

TOLERANCE(.XX±0.05)

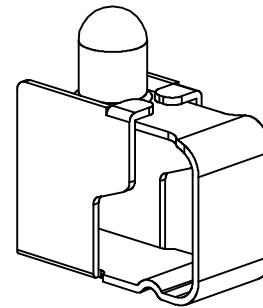
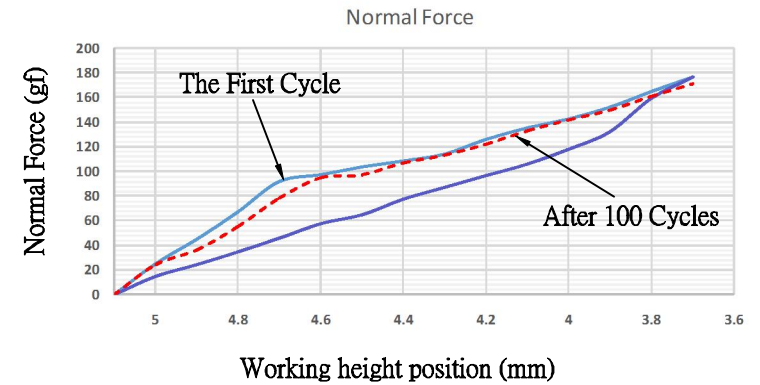
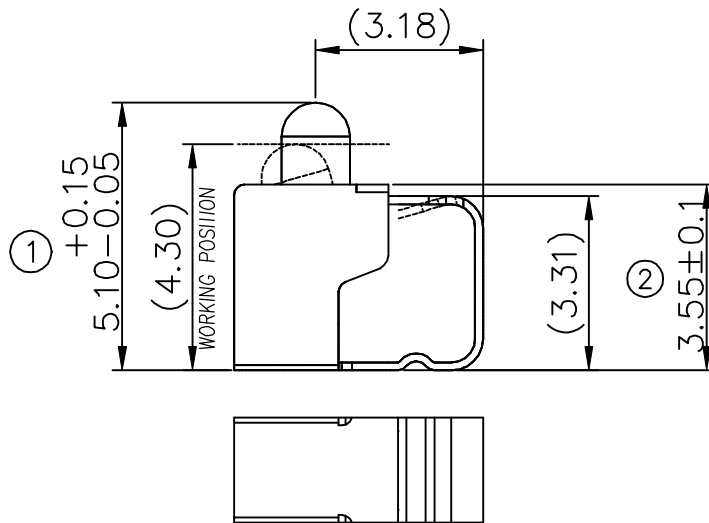
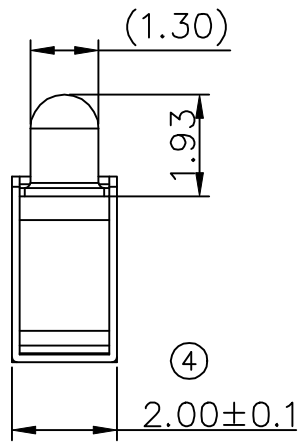

Note:

1. Material: Phosphorus Bronze Thickness 0.15mm
2. Electroplate:
Gold Flash on contact area
Gold Flash on solder area
Nickel underplating over all
3. Electrical Characteristics:
3-1 Current Voltage: 12V
3-2 Current Rate: 3A
3-3 Contact Resistance: Normal Compression < 30mΩ
4. Working Height of Application: 3.70~4.60 mm
5. Spring Force Tolerance is ±20gf
6. Operating Temperature: -20°C~+85°C

00	2016-03-22	Design creation			
DRAFT	DATE	RoHS Compatible			
Hardy Hsieh	2016-03-22				
CHECKER	DATE	SHEET	SCALE	UNIT	
Justin Wu	2016-03-22	1-2	Not to scale	mm	
APPROVAL	DATE				
Jacky Lin	2016-03-22				

TOLERANCE/CLASS			
RANGE(mm)	A	B	C
≤30	±0.10	0.15	0.20
30 < ~ ≤120	±0.15	0.20	0.30
120 < ~ ≤300	±0.20	0.30	0.50
300 <	±0.30	0.50	0.80
ANGLES	±2.5°		



EMI STOP

EMI STOP CORP.

EMISTOP P/N
QQ-51K1Q1G

CUS P/N