

RECOMMENDED SOLDERING PCB LAYOUT
TOLERANCE(.XX±0.05)

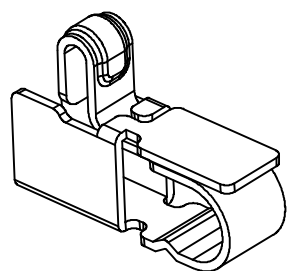

Note:

- Material: Titanium copper Thickness 0.12mm
- Electroplate:
Gold Flash on contact area
Gold Flash on solder area
Nickel underplating over all
- Electrical Characteristics:
3-1 Current Voltage: 12V
3-2 Current Rate: 3A
3-3 Contact Resistance: Normal Compression<30mΩ
- Working Height of Application: 1.50~2.10 mm
- Spring Force Tolerance is ±20gf
- Operating Temperature: -20℃~+85℃



01	2021-08-05	PAD modified		
DRAFT	Peter Ding	DATE	2021-08-05	RoHS Compatible
CHECKER	Justin Wu	DATE	2021-08-05	
APPROVAL	Timothy Cheng	DATE	2021-08-05	SHEET 1-2
		SCALE	Not to scale	UNIT mm

TOLERANCE/CLASS			
RANGE(mm)	1	2	3
≤30	±0.10	0.15	0.20
30<- ≤120	±0.15	0.20	0.30
120<- ≤300	±0.20	0.30	0.50
300<	±0.30	0.50	0.80
ANGLES	±2.5°		

EMI STOP CORP.
EMI STOP
EMISTOP
QTT-25G

CUS P/N