

RECOMMENDED SOLDERING PCB LAYOUT
 TOLERANCE(.XX±0.05)

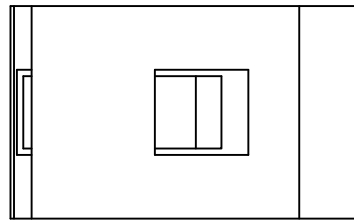

Note:

- 1. **Material:** Titanium Copper **Thickness** 0.08 mm
- 2. **Electroplate:** Nickel underplating over all, Gold Flash over all
- 3. **Electrical Characteristics:**
 - a. **Current Voltage:** 12V
 - b. **Current Rate:** 3A
 - c. **Contact Resistance; Normal Compression** <30mΩ
- 4. **Working Height of Application:** 2.4~3.6 mm
- 5. **Spring Force Tolerance** is ±20gf
- 6. **Operating Temperature:** -20°C~+85°C

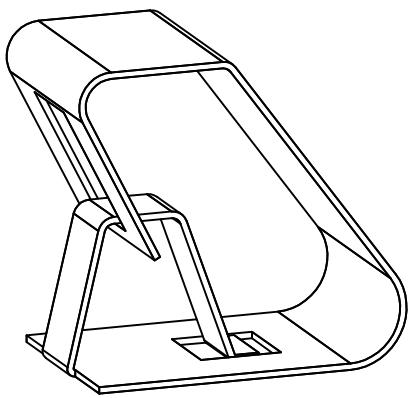

00	2022-09-22	Design Creation			
DRAFT	DATE	RoHS Compatible			
Ray Shiung	2022-12-27				
CHECKER	DATE				
Robin Liao	2022-12-28	SHEET	SCALE	UNIT	☉
APPROVAL	DATE	1-2	Not to scale	mm	
Justin Wu	2022-12-29				

TOLERANCE/CLASS			
RANGE(mm)	A	B	C
≤30	±0.10	0.15	0.30
30 < ~ ≤120	±0.15	0.20	0.40
120 < ~ ≤300	±0.20	0.30	0.50
300 <	±0.30	0.50	0.80
ANGLES	±2.5°		

EMI STOP CORP.
 EMI STOP
 EMISTOP P/N SQ-39Q2G CUS P/N